

Timing of Double Cylinder for Classroom Intruder C877 & Store Lock C866



A. OUTSIDE

1. Determine Handing of DOOR

Make sure LH(Left Handed) or RH(Right Handed) door before installation.

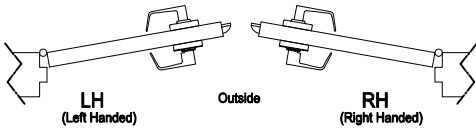

2. Check Lock Status

Use Screwdriver to turn the outside spindle as (Figure 1) and retract the latchbolt in order to make sure the lock is in **unlocked** mode.

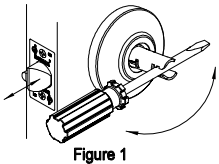

3. Determine Handing of LOCK

A. For RH door, to use the flat head screwdriver to turn the breach of CAM face up. (Figure 2)

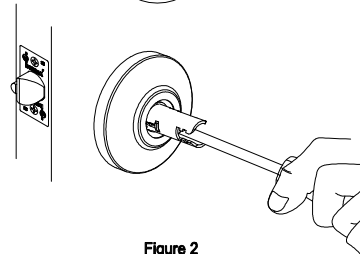
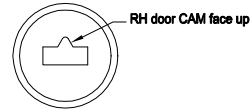

B. For LH door, to use the flat head screwdriver to turn the breach of CAM face down. (Figure 3)

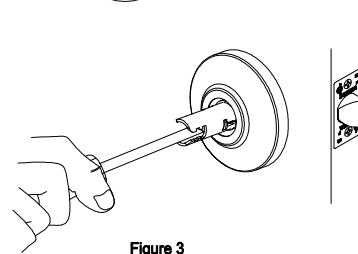
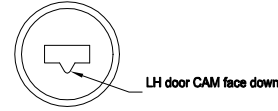

4. Install Cylinder and Lever

A. With cylinder and key in lever, align hole in lever with lever catch on spindle assembly until the tailpiece is engaged into the CAM and rotate key **45° clockwise(CW)**.

B. Push lever in to engage lever catch.

C. Check function before closing door by following steps:

- Rotate key **270° clockwise (CW)** for locked mode then rotate **270° counter clockwise (CCW)** to remove key.
- Rotate key **180° counter clockwise (CCW)** for unlocked mode then rotate **180° clockwise (CW)** to remove key.

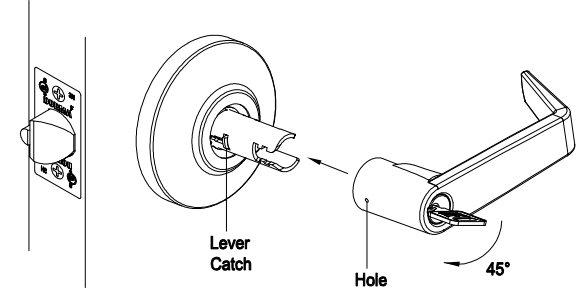

B. INSIDE

1. Determine Handing of DOOR

Make sure LH(Left Handed) or RH(Right Handed) door before installation.

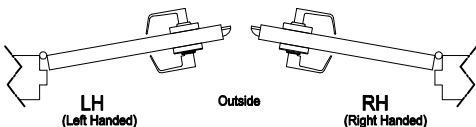

2. Check Lock Status

Turn the outside lever as (Figure 1) and retract the latchbolt in order to make sure the lock is in **unlocked** mode.

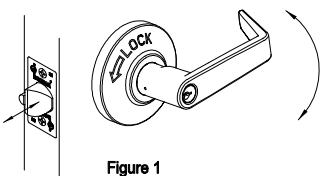

3. Determine Handing of LOCK

A. For RH door, to use the flat head screwdriver to turn the breach of CAM face up. (Figure 2)

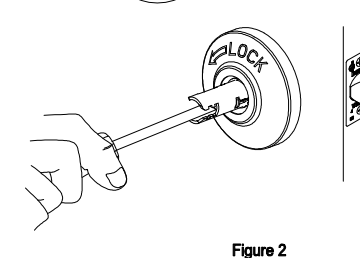
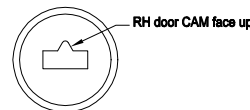

B. For LH door, to use the flat head screwdriver to turn the breach of CAM face down. (Figure 3)

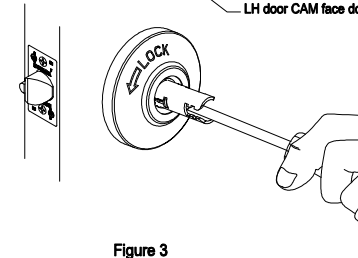
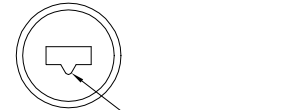

4. Install Cylinder and Lever

A. With cylinder and key in lever, align hole in lever with lever catch on spindle assembly until the tailpiece is engaged into the CAM and rotate key **45° clockwise (CW)**.

B. Push lever in to engage lever catch.

C. Check function before closing door by following steps:

- Rotate key **270° counter clockwise (CCW)** for locked mode then rotate **270° clockwise (CW)** to remove key.
- Rotate key **180° clockwise (CW)** for unlocked mode then rotate **180° counter clockwise (CCW)** to remove key.

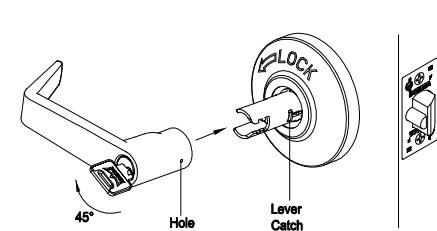

Timing of Double Cylinder for Classroom Intruder C877 & Store Lock C866 (I/C)



A. OUTSIDE

1. Determine Handing of DOOR

Make sure LH(Left Handed) or RH(Right Handed) door before installation.

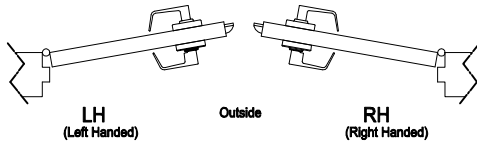

2. Check Lock Status

- Insert lever onto spindle.
- Turn the outside lever as (Figure 1) and retract the latchbolt in order to make sure the lock is in **unlocked mode**.

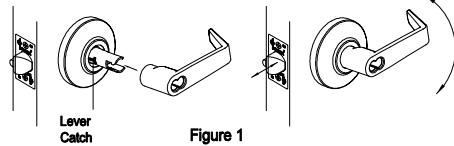

3. Determine Handing of LOCK

- For RH door, to use the flat head screwdriver to turn the breach of CAM face up. (Figure 2)

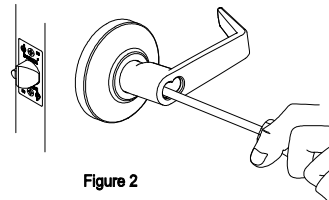
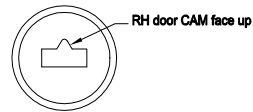

- For LH door, to use the flat head screwdriver to turn the breach of CAM face down. (Figure 3)

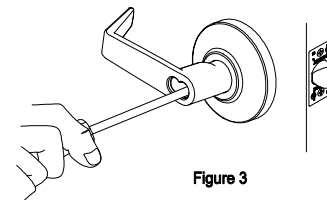
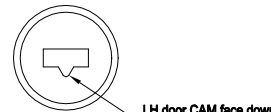

4. Install IC Core

- With control key in core rotate 15° **clockwisely (CW)** and insert fully into lever.
- Turn the key **counter clockwisely (CCW)** and remove control key.
- Check function before closing door by following steps:
 - Rotate key 270° **clockwisely (CW)** for locked mode then rotate 270° **counter clockwisely (CCW)** to remove key.
 - Rotate key 180° **counter clockwisely (CCW)** for unlocked mode then rotate 180° **clockwisely (CW)** to remove key.

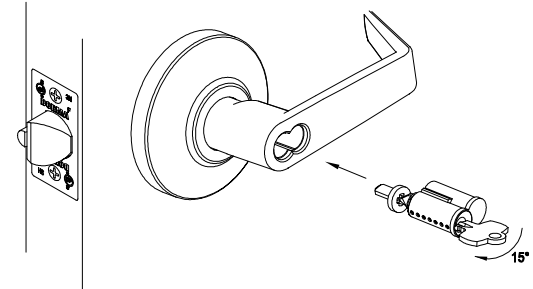

B. INSIDE

1. Determine Handing of DOOR

Make sure LH(Left Handed) or RH(Right Handed) door before installation.

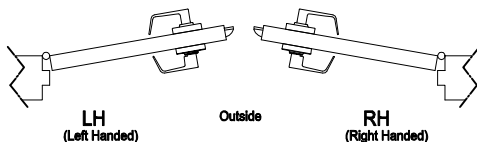

2. Check Lock Status

- Insert lever onto spindle.
- Turn the outside lever as (Figure 1) and retract the latchbolt in order to make sure the lock is in **unlocked mode**.

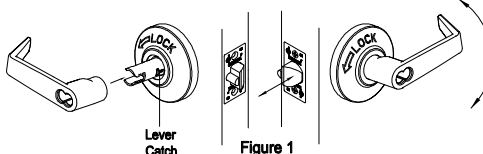

3. Determine Handing of LOCK

- For RH door, to use the flat head screwdriver to turn the breach of CAM face up. (Figure 2)

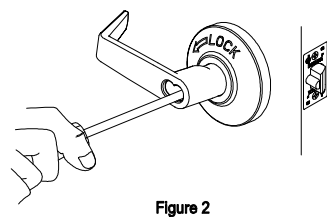
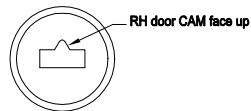

- For LH door, to use the flat head screwdriver to turn the breach of CAM face down. (Figure 3)

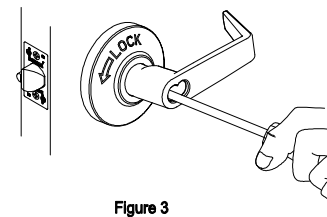
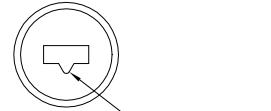

4. Install IC Core

- With control key in core rotate 15° **clockwisely (CW)** and insert fully into lever.
- Turn the key **counter clockwisely (CCW)** and remove control key.
- Check function before closing door by following steps:
 - Rotate key 270° **counter clockwisely (CCW)** for locked mode then rotate 270° **clockwisely (CW)** to remove key.
 - Rotate key 180° **clockwisely (CW)** for unlocked mode then rotate 180° **counter clockwisely (CCW)** to remove key.

