

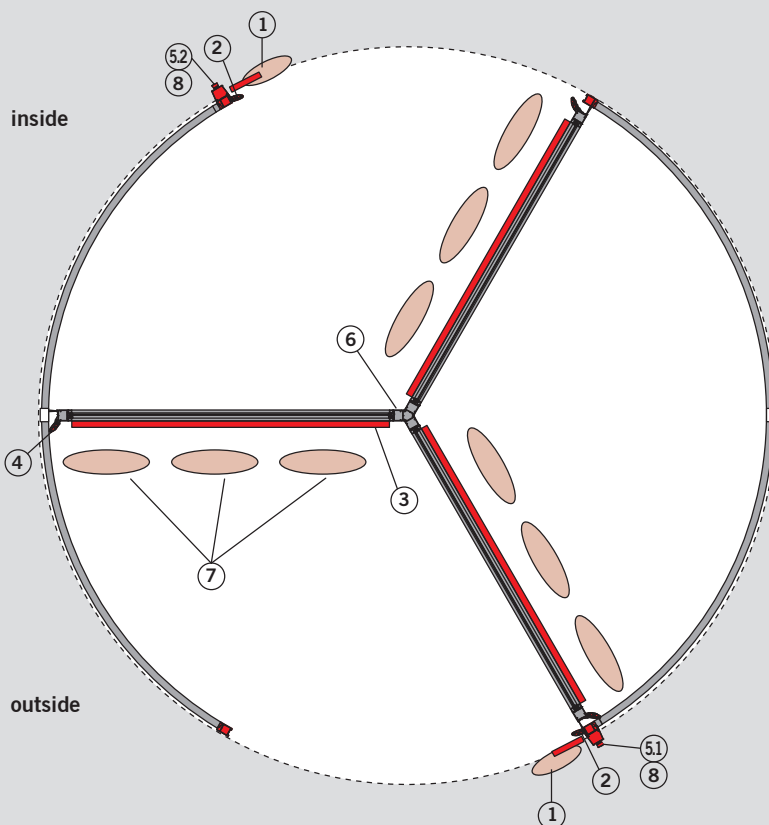

Revolving doors  
Varioline

# **DORMA** **KTV-3/4** **Secure**

### Safety equipment for KTV/A, 3- and 4-wing design

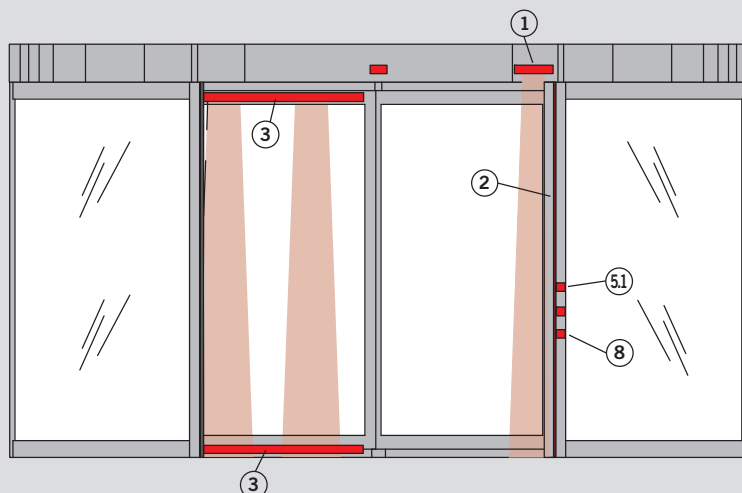

	Function
① Canopy-integrated sensor (door post, top/canopy)	Slow cycle/stop
② Rubber strip (door post)	Impact protection
③ Safety contact strip (wing, bottom)	Stop
④ Safety contact strip (wing, top)	Stop
⑤.1 Emergency pushbutton (door post/near the door, external)	Stop
⑤.2 Emergency pushbutton (door post, internal)	Stop
⑥ Limit switch for deflection device (only for pivot-mounted wings)	Stop
⑦ Limit switch for deflection device (only for pivot-mounted wings)	Slow cycle/stop
⑧ Disabled access pushbutton (door post)	Slow cycle

DORMA KTV Varioline revolving doors equipped with Automatic operators offer a comprehensive range of safety equipment.

#### Fail-safe function

After the emergency push-button has been activated, the turnstile is disengaged from the drive unit and can then be rotated freely.

#### Please note:

Safety equipment has to be selected according to the national requirements.

In order to comply with DIN 18650, doors require all below-mentioned safety equipment. (Depending on the users, ⑧ can be left out.)

**KTV versions for secured access**

DORMA KTV revolving doors can be fitted with security equipment for controlled access depending on their equipment and the prevailing version/configuration.

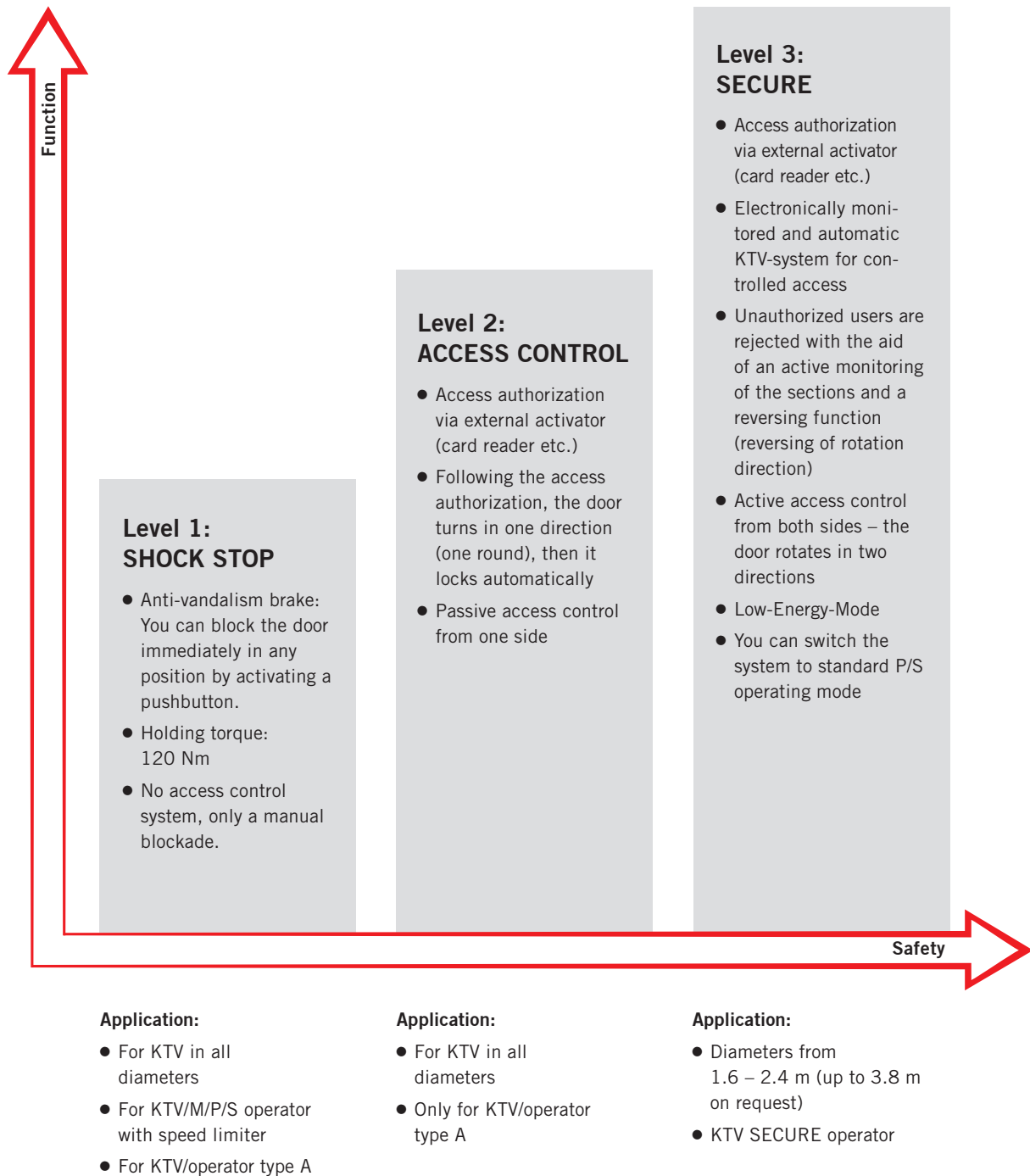

**KTV SECURE**

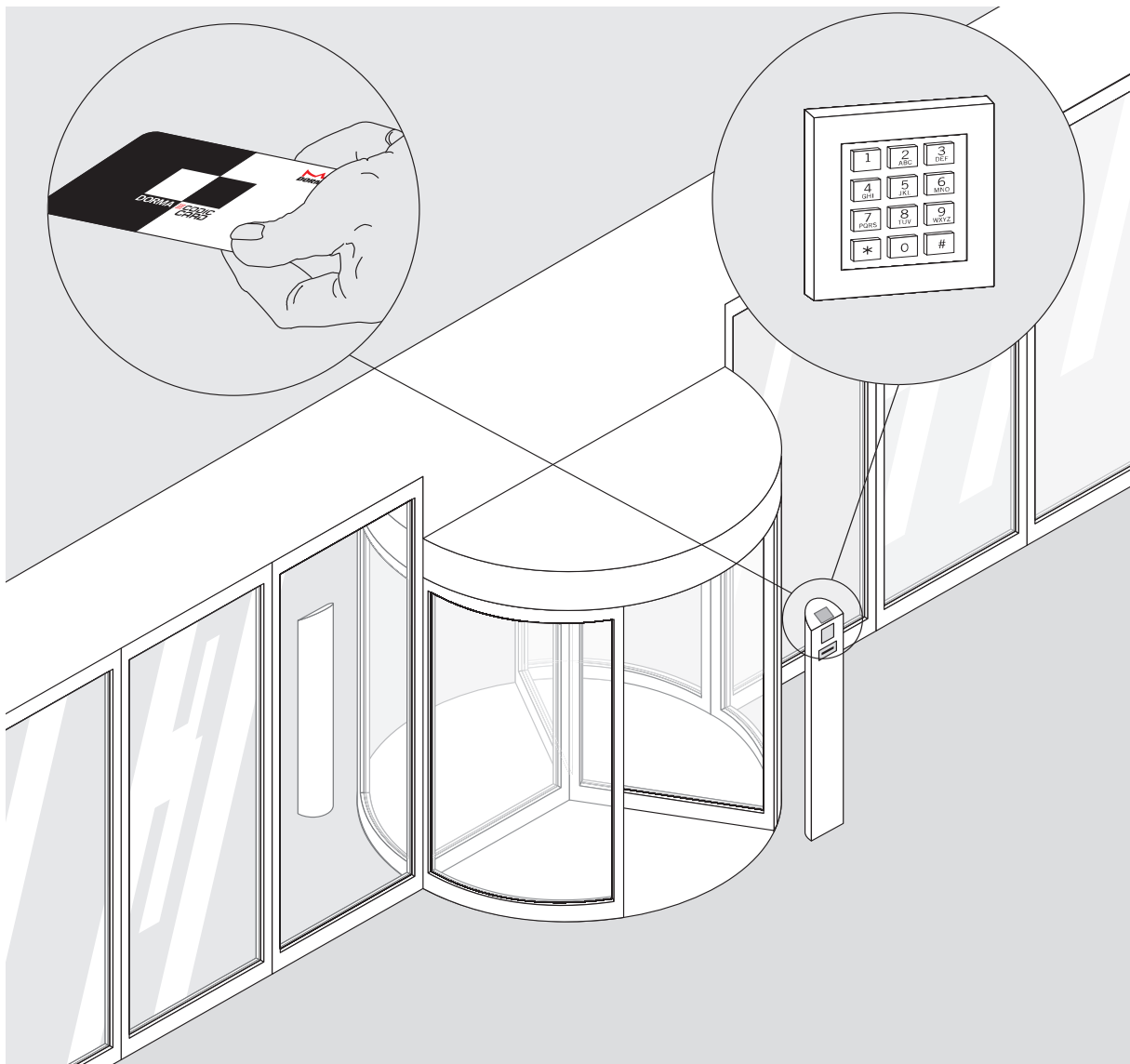
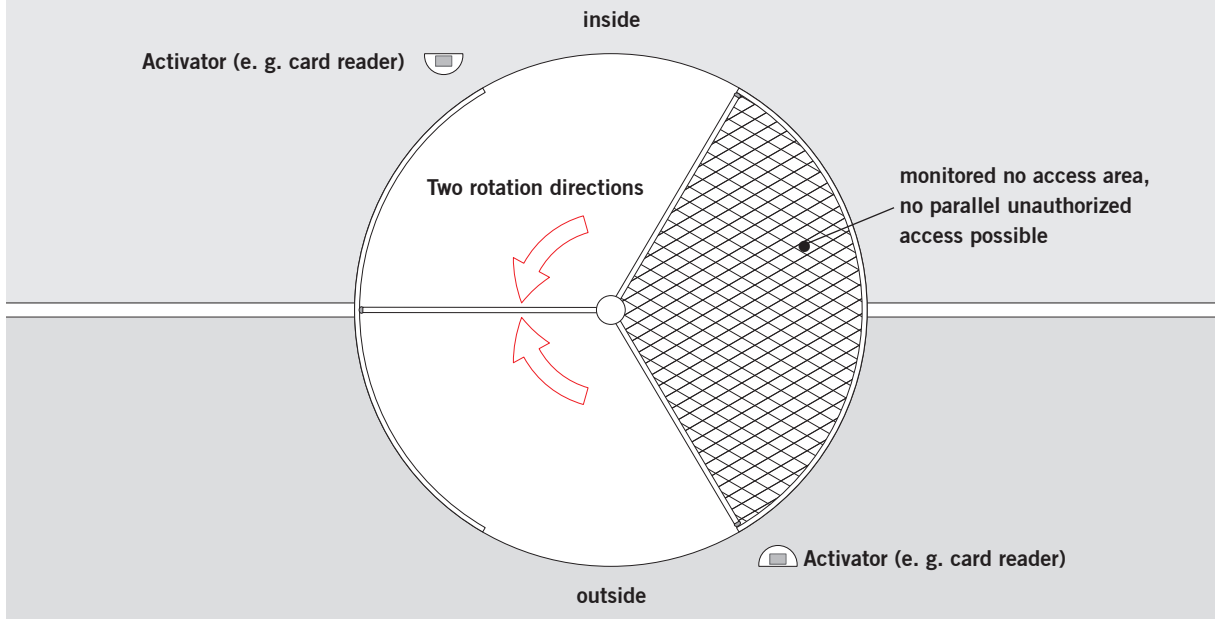

## Automatic Division worldwide

DORMA GmbH + Co. KG  
Breckerfelder Str. 42-48  
D-58256 Ennepetal  
Phone +49 23 33/793-0  
Fax +49 23 33/793-495

### Region Australia AUS, NZ

Australia  
DORMA Automatics Pty. Ltd.  
Phone +61 3 97964111  
[www.dorma.com.au](http://www.dorma.com.au)

New Zealand  
DORMA Automatics Pty. Ltd.  
Phone +61 3 97964111  
[www.dorma.com.au](http://www.dorma.com.au)

### Region Central Europe D, NL, B, LX, CH

Germany  
Automatic D  
Phone +49 2333 793-0  
[www.dorma.de](http://www.dorma.de)

Netherlands  
DORMA van Duin Nederland BV  
Phone +31 488 418 100  
[www.dorma.nl](http://www.dorma.nl)

Belgium  
DORMA foquin N.V./S.A.  
Phone +32 50 312849  
[www.dorma.be](http://www.dorma.be)

[www.dorma.com](http://www.dorma.com)



Door Control



Automatic



Glass Fittings and  
Accessories



Security/Time and  
Access (STA)



Movable Walls