

RCI WPDT

Wireless Power & Data Transfer



The RCI wireless power and data transfer (WPDT) is an innovative and less intrusive way of wirelessly transferring low voltage power and data signals between a door and frame.

Features

- Ideal for situations where power cannot be routed to an electric lock in the door.
- Enables less wire runs to various points of the door.
- Eliminates a power transfer hinge or other method of power transfer.
- Two-piece device has an RF receiver and transmitter – transmitter resides on the frame side while the receiver resides in the door.
- For fail secure devices only.
- Power is delivered to the transmitter that transfers power/data wirelessly to the receiver.
- Dual voltage selectable power output – 12VDC/24VDC.
- Ability to monitor RX, LBM, DBM (max 2 signals).
- Status indicators (frame & door side).
- Monitoring function(s) report change of state of the lock switches back to a control panel.
- UL 10C, Classified as a miscellaneous fire door accessory.
- FCC compliant.
- ISED compliant.
- Patent: US 9,235,942 B2



Miscellaneous Fire
Door Accessory

Dimensions

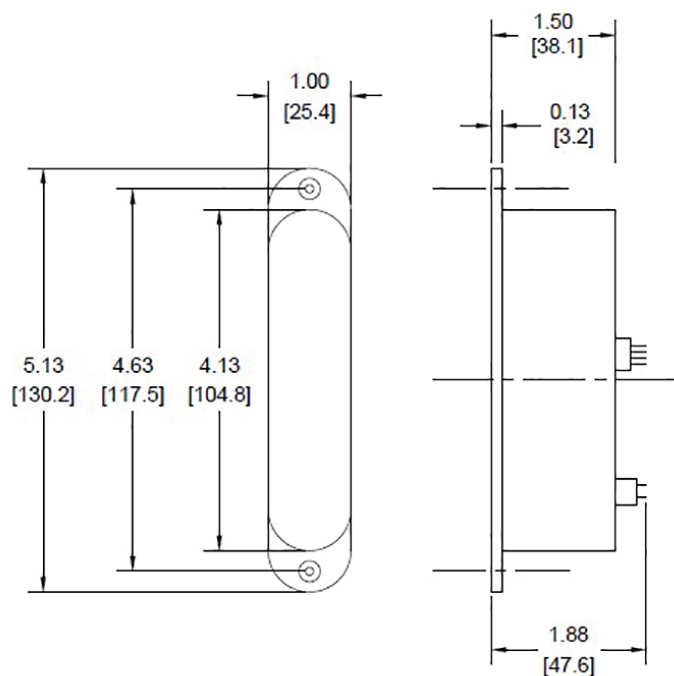

Dimensions are not to scale. Dimensions are in inches.

Specifications

Energy	Output voltage – 12VDC/24VDC field selectable.
	Output amperage - 600mA/12VDC 300mA/24VDC.
	Minimum input power – 600mA @ 24VDC.
Housing	Available with radius or square corners.
Certifications and listings	UL 10C, Classified as a miscellaneous fire door accessory FCC compliant ISED compliant
Patent #	US 9,235,942 B2

© dormakaba 2019 Information on this sheet is intended for general use only. dormakaba reserves the right to alter designs and specifications without notice or obligation.

dormakaba Canada Inc.
65 Struck Court
Cambridge, Ontario
Canada N1R 8L2
1-800-265-6630
sales_RCI@dormakaba.com
dormakaba.us

ZLWPDT-0719