

# Keyscan LUNA™ SDACSKT

## Single Door Access Control Smart Kit

dormakaba 



## Total control for single door access

The Keyscan LUNA™ Single Door Access Control Smart Kit (SDACSKT) contains:

- SDAC single-door access control unit
- PS1225 Plug-in 12VDC transformer power supply
- K-SMART3 13.56 MHz mobile-ready reader
- K-SECURE1K10 package of 10 card credentials

The access control unit is quickly configured and installed. It features two reader ports allowing a single door in or out reader or a single door with in and out readers controlled by an electric strike or electromagnetic lock depending on your project specifications.

The combination of single access control unit, one reader, 10 credentials, power supply and comprehensive software, brings affordable access control security, accountability, and reporting to small businesses for a fraction of the cost of enterprise systems.

To order the SDACSKT contact your local dormakaba EAD representative.

To begin, simply download Keyscan LUNA software.

### LUNA™ Software Capabilities:

- People Management: manage users, assign credentials and permissions.
- Hardware management: install, configure and operate up to 6 SDAC control units.
- Can program select E-Plex offline electronic locks.
- Settings: adjust performance and preferences.
- Access levels: set permission levels and user groups.
- Schedules: for pre-authorized entry times.
- Transaction reports: for audits and investigations.

### LUNA™ Software Benefits:

- Comprehensive and easy to use.
- Encrypted database.
- Software for small business access control needs.
- Downloadable and can be run from a USB drive.
- No licensing or recurring fees.

## Features and benefits

- A convenient and cost-effective single door control solution featuring: SDAC Unit; K-SMART3 reader; K-SECURE1K10 (10-pack) credentials, 12VDC 2.5Amp transformer power supply - all in one package.
- 1 powered relay (up to 500mA at 12 VDC) for electric strike or electromagnetic lock (sold separately).
- Network configuration WiFi embedded web server.
- Fast and convenient WiFi point-to-point or WLAN connectivity only.
- DIP switches for system options.
- Selectable filter transaction reports.
- Use LUNA to program additional E-Plex 7900, 3x00 and 5x00 Series electronic locks (requires M-Unit handheld & E-Plex locks sold separately)

## Typical WiFi installation:

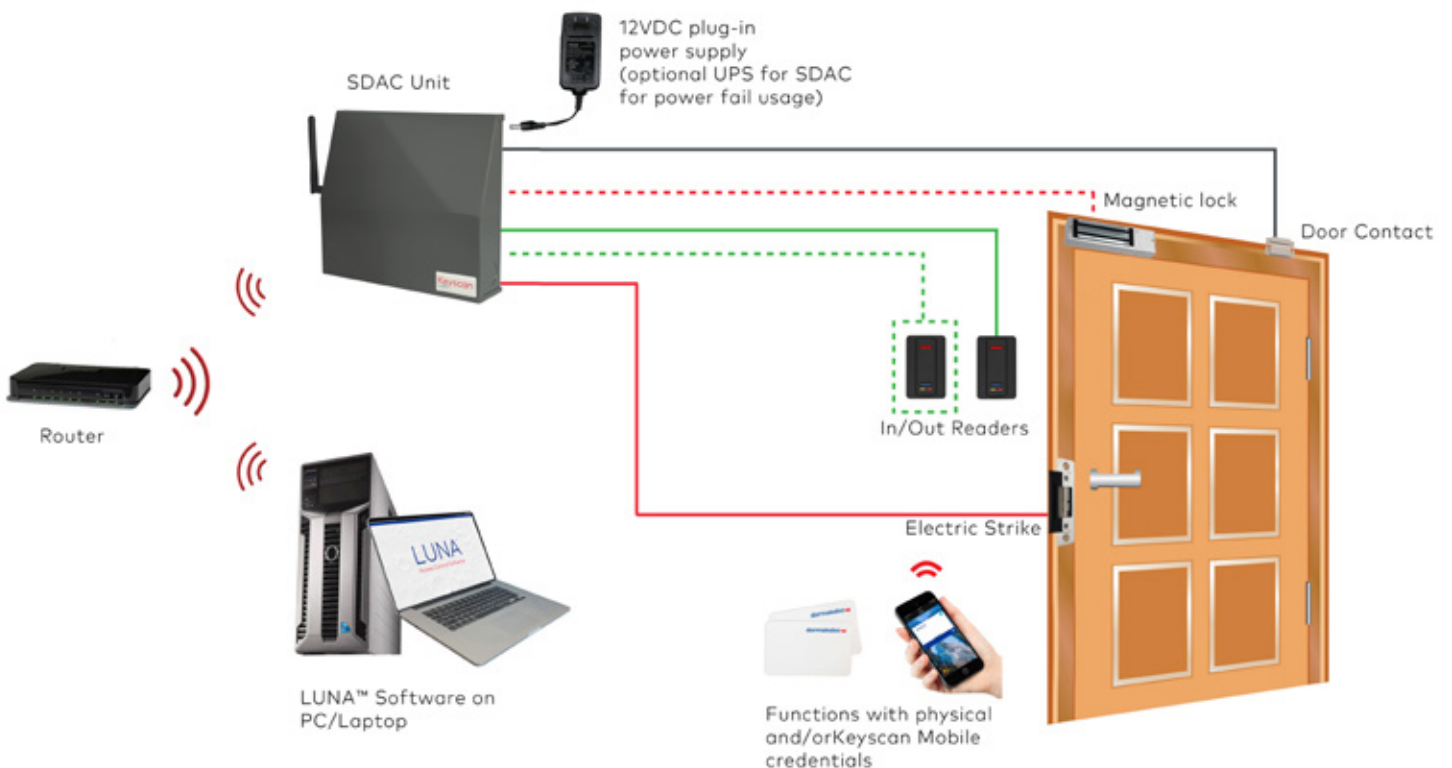

## SDAC Specifications

Doors supported	1
Reader ports	2 (in/Out)
Dimensions	W - 6.875 " (17.46 cm) x H - 7.625 " (19.37 cm) x D - 1.75 " (4.45 cm)
Weight	1.7 lbs (780g)
Housing	22 GA steel, gray powder coat
Environmental	Operating Temperature: 32° F to 120° F (0° C to 49° C) Humidity: 0 % to 90 % R.H, non-condensing
Power Inputs	+12V DC from supplied plug-in transformer or independent power supply
SDAC Current	170 mA to maximum 200 mA
Communication	802.11 Wireless b/g/n Adapter
PTC Resettable Fuses	Reader port 1 - Up to 500 mA Reader port 2 - Up to 500 mA Door output - Up to 500 mA RTE port - Up to 300 mA
Software Requirements	LUNA™
Applications	Indoor installations only

## LUNA Software Specifications

Processor	Intel Core i3 equivalent or better
RAM	8 GB RAM, 2400 MHz, DDR4
Hard Drive	100 GB of free space
Operating Systems	Windows 10 Home/Professional/Enterprise Windows 8 Professional/Enterprise Windows 7 Home/Professional/Ultimate
Communication	802.11 Wireless b/g/n Adapter
Peripherals	Keyboard & Mouse USB Port Minimum screen resolution of 1024 x 768 ppi
Offline Locks Supported (optional)	E-Plex 7900, 5600, 5700, 3600, 3700 series

## K-SMART3 Specifications

Dimensions	Mullion: 4.4375" x 1.6875" x .6875" (11.5 cm x 4.49 cm x 1.7 cm) Switch Plate: 4.75" x 3" x .625" (12 cm x 7.6 cm 1.6 cm)
Credential Read Range	On or off metal: 1" (3 cm) with ISO type card
Mobile credential read range	Four BLE read ranges: Short range (default), Medium range; Long range; Maximum range (all read ranges are subject to installation of reader and type of mobile device used)
Input voltage	12VDC at reader
Typical current draw	125mA
Cable Distance	12" wire pigtail standard; Wiegand interface 500 feet (152 meters); 6 conductor shielded 22 AWG
Operating Temperature	- 40° F to 150.8° F (- 40° C to 66° C)
BLE programming card	BLE1 card to program BLE reader range setting—short, medium, long or maximum (package of five identical programming cards, sold separately) Only required if Keyscan mobile credentials are being used and read range adjustment is required.
Environmental	Secured in a rugged, tamper-resistant epoxy potting designed to with-stand harsh weather conditions. Easily installed in any location.
Connections	Connections must be in accordance with NFPA 70. Reader and/or control unit power sources must not be connected to a receptacle controlled by a switch.

## K-SECURE1K Specifications

Frequency	13.56 MHz smartcard
Formats	Keyscan 36-bit
Material	Gloss white PVC
Marking	Card batch and card number
Read Range	1" (24.4 mm) with ISO card style.
Outputs	Wiegand format, Secure Sector Batch & Card number
Dimensions	2.1" W x 3.3" H x 0.031" D (54 mm x 85 mm x 0.79 mm)
Weight	0.19 oz (5.4 g)
Environmental tolerances	-35° F to 122° F (-37° C to +50° C); 0-95% non-condensing
Memory	1K & 4K, suitable for 3rd party applications (biometrics, logical network access and cashless vending).
ISO Standards Technology	Graphics quality; ISO 14443; Size: ISO 7810 (ID-1) (CR-80)
Reader Compatibility	Keyscan K-SMART3; K-SMART; K-SKPR readers
Customization	Contact dormakaba Canada for custom graphic images on cards.

# Peripheral and Replacement Products



## K-SMART Smartcard BLE Reader

You'll receive one K-SMART3 13.56 high frequency smartcard reader with your SDACSKT purchase. If you require a replacement K-SMART3 reader or wish to add another reader to your SDAC, they are available.

Part No: K-SMART3



## K-SECURE credentials

You'll receive a 10 pack of K-SECURE 1k credentials with your SDACSKT purchase. Additional K-SECURE series credentials are available in both 1K or 4K memory cards or 1K keyring Fobs.

Part No: K-SECURE1K10 (10 pack, cards)  
K-SECURE 1K memory (50 pack, cards)  
K-SECURE 4K memory (50 pack, cards)  
K-SF-1K memory (50 pack, Fobs)



## SDAC Replacement WiFi Antenna

If you require a replacement WiFi antenna for use with SDAC access control unit these are readily available.

Part No: SDRA



## PS1225 Plug-in power supply replacement

You'll receive one plug-in 12VDC power supply transformer with your SDACSKT. If you need to replace this transformer power supply it is available separately.

Part No: PS1225

©2022 dormakaba. Information on this sheet is intended for general use only. dormakaba reserves the right to alter designs and specifications without notice or obligation.

dormakaba Canada, Inc  
7301 Decarie Blvd,  
Montréal, Quebec  
Canada H4P 2G7

1 888 539 7226

[www.dormakaba.us](http://www.dormakaba.us)

KKT2081\_02-22