



 Wireless

 Mobile Access

 TouchGo

dormakaba c-lever pro

Design and security

Security and design in one

The new electronic c-lever pro door furniture offers a sophisticated design combined with a wide range of functions.

You can control access precisely for an almost unlimited number of users according to specific places and time periods. You set access rights and can change them quickly and flexibly, in standalone, remote or online mode. Furthermore, you can grant access rights to smartphones so that they may be used as access media at the door.

For outside doors or doors with increased security requirements, the c-lever pro not only offers burglary and fire protection, but also provides solutions for emergency exits and escape routes. The high-quality materials meet the most demanding requirements in relation to robustness, weather resistance and security.

State-of-the-art technology

The c-lever pro is part of the consistent standalone-portfolio dormakaba evol. It supports the latest RFID technologies and is available with the wireless function: access rights are transmitted from your PC to the door components, wirelessly and in real time. This offers enormous advantages in terms of security, convenience, programming and maintenance.

If you don't want to search for your keys, choose the TouchGo option. The door furniture detects whether the user carries a valid transponder on his person and if so, allows the door to be opened.

Ready for you to use

Its large variety of options makes the c-lever pro suitable for almost every door, both inside and outside. These doors might be the access points to commercial or administration buildings, retirement homes, hospitals, universities or any area worth protecting, like server rooms or storage facilities.

Advantages at a glance:

- Suitable for outside and security doors (burglary resistant and weather protection)
- Door monitoring with the wireless function
- TouchGo function: your hands are free, the transponder stays in your pocket
- Supports Mobile Access: receive your access right on your smartphone using the dormakaba app

Questions? We would be pleased to advise you and look forward to hearing from you.

dormakaba Deutschland GmbH

DORMA Platz 1
D-58256 Ennepetal
T. +49 2333 793-0
info.de@dormakaba.com
www.dormakaba.de

dormakaba Austria GmbH

Ulrich-Bremi-Strasse 2
A-3130 Herzogenburg
T. +43 2782 808-0
office.at@dormakaba.com
www.dormakaba.at

dormakaba Schweiz AG

Hofwisenstrasse 24
CH-8153 Rümlang
T. +41 848 85 86 87
info.ch@dormakaba.com
www.dormakaba.ch

Features

Sophisticated design

You can operate the door easily: whether it's with a card, key fob, a key with RFID or a smartphone – the green signal of the digital lighting unit will appear after presenting your access medium, and you can open the door with the lever handle as usual. Our clever engineering ensures that standard batteries provide sufficient power for up to 150,000 door movements.

Easy to install

Installation is carried out indoors or in outside areas protected against weather directly on doors made of wood, plastic or metal. Usually, you can continue to use your existing lock. The standalone operation needs no wiring.

Scalable application

The c-lever pro is suitable for single doors but also as part of a large-scale master key system. Choose from the following programming options:

- Authorisation in the component:
 - manually with the programming card
 - with the system software and transfer of access rights via programming device
 - conveniently from your desk via the wireless function
- Authorisations on the access medium – programming of the door components on site is not necessary. Optionally available with:
 - CardLink
 - AoC (Access on Card)
 - OSS-SO (Open Security Standards – Standard Offline)
 - Mobile Access: Access using a smartphone via Bluetooth (BLE) or Near Field Communication (NFC)

Essential features

The device software supports all dormakaba system solutions and its functions also include:

- Number of access media: - with whitelist up to 4,000
 - with CardLink practically unlimited
- Internal clock and configurable time profiles
- Time-limited assignment of access rights (validation)
- Saving of last 2,000 events (can be disabled)

A universal portfolio

Our range includes a variety of combinable products in the same high-quality design. They can be seamlessly integrated into mechanical, standalone or online dormakaba systems.

For further details and order information, please check the relevant dormakaba evolo catalogue or system description.

Please note: the range of functions of the product depends on the system environment chosen. Some versions and options are not yet available.

Technical data

Supported RFID Standards

- LEGIC (advant & prime)
- MIFARE (DESFire & Classic)
- OSS-SO (LEGIC advant, version 1.00)

Designs

- Plate: choice of wide or narrow
- Centre distance: 55 to 105 mm (depending on profile)
- Euro profile, Swiss round profile, Scandinavian or Australian oval profile

Options

- Black or white cover
- Choice of lever handle designs
- Available functions: TouchGo, Wireless and Mobile Access with BLE

Dimensions (W x H x D)

- Narrow plate: 39.8 x 298 x 21 mm
- Wide plate: 53.6 x 298 x 21 mm
- Minimum backset 35 mm, 25 mm with offset lever handles

Power supply

- 2 batteries 1.5 V AA L91, FR6 or via the S module
- For TouchGo, together with filter box

Environment/service life

- Temperature: -25 °C to +70 °C
- Protection class: IP54
- Humidity: 0 to 95 %, non-condensing
- Battery life at 20 °C: up to 150,000 cycles or up to 3 years

Certificates

- Building hardware: EN 1906, application class 4
- Fire safety: DIN 18273 (tested as per EN 1634-1)
- Emergency exit: EN 179 (in combination with appropriate lever handles and locks)
- Panic doors: EN 1125 (in conjunction with approved panic push bars)

Subject to technical changes.

Version 06/2018. © 2018 dormakaba.

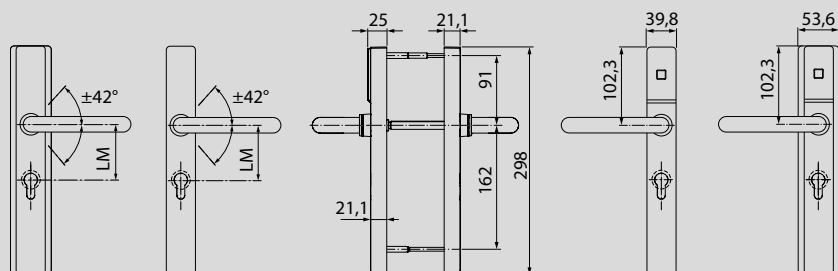

c-lever pro, standard version. Type 2621 (narrow) and 2622 (wide)
Drawing showing cylinder profiles EU (solid line) and Swiss round profile (dotted line)

