

# 1250 DOOR LIMITER - Fitting Instructions



1. Install Track Section (1) to frame and secure with screws supplied as recommended in diagram for pull or push side of door. Ensuring roller assembly (6) and door limiter block (4) (Including Hold open Spring (2) if required\*) and end caps (3) are inserted into track section before securing screws.

2. Install Shoe bracket (8) with 2 x 10g x 25mm Screw supplied as recommended in diagram for pull or push side.

3. Install Arm assembly (7) to roller assembly and secure with grub screw (10) in end of arm.

4. Install other end of arm into shoe bracket (8) using pivot pin (9) and secure with grub screw on bracket.

5. Set hold open angle as required by tightening 2 x Grub screws (5) on door limiter block (4) in desired position. (Ensure Hold Open spring (2) is inserted).

6. Hold open strength can be adjusted by tightening or loosening grub screw in under side of roller (6).

**Note:** Max. recommended

Hold Open angle is 130°

\*If Hold Open is not required, please discard hold open spring.

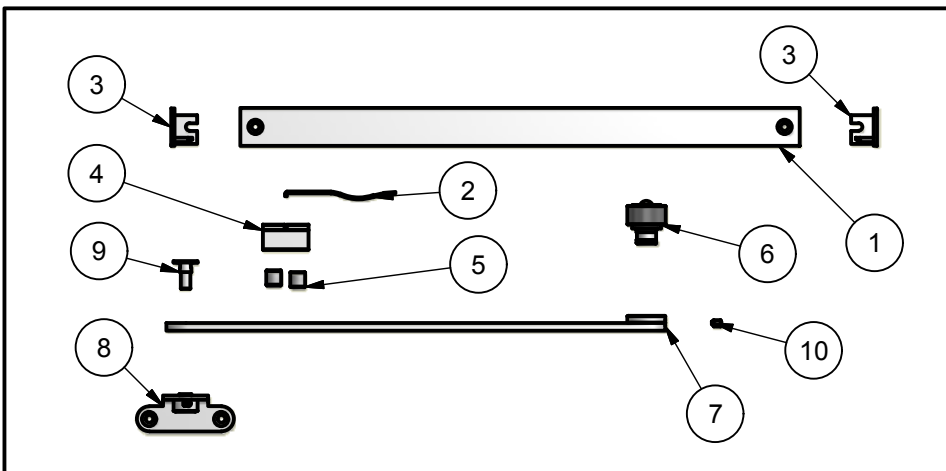

## 1250 PULL SIDE MOUNTING

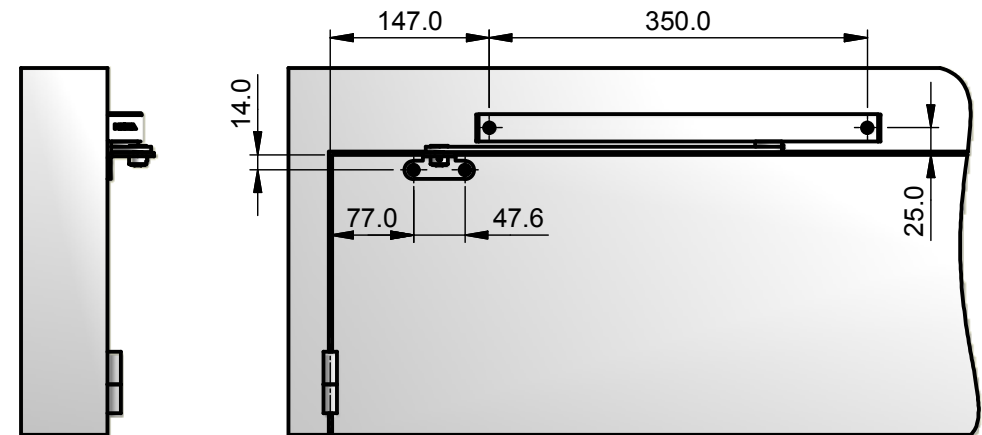

## 1250 PUSH SIDE MOUNTING

