



Wireless

## Kaba digital cylinder access made easy

### Innovative and user-friendly

The digital cylinder controls access to the right areas at the right times. Along with high-quality, award-winning design, the locking system offers maximum security and flexibility, as well as simple programming of the master key system. The digital cylinder is part of the evolvo product family and supports current RFID technologies.

The system is extremely easy to use: simply hold the badge, the key fob or the key with RFID up to the outside knob and the cylinder will emit a visual and acoustic signal to indicate whether access can be granted.

The modular design of the digital cylinder with removable knobs enables extraordinarily simple installation. No cabling is required within the door because the unit is powered by a standard battery.

### Diverse range of uses

The digital cylinder is suitable for any interior or weather-proofed exterior door, making it a very versatile solution. The electronics operate reliably, even in extremely low temperatures.

### Extensive range

In addition to the standard version, the product portfolio includes dual, half cylinders. These can be combined with a variety of options, such as high pick resistance, available in black and white face.

The option with wireless enables online connection to the access system and therefore offers many advantages in terms of programming, maintenance and beyond that, an extremely high level of security.

### Advantages at a glance

#### Quick installation

Quick and easy retrofit from mechanics to electronics

#### Innovative, high-quality design

Award-winning knob design offers a perfect touch

#### Future-proof

Integration of NFC-enabled devices (NFC: Near Field Communication)

#### Security and functionality

Security features built into the protected cylinder core

#### Wireless function

Programming from the comfort of your own desk: the new wireless solution connects the digital cylinder to your system



# Features

## Intuitive to use

The high-performance, energy-efficient electronics detect the RFID access media. An acoustic and visual signal (illumination unit turns green or red) indicate whether or not access is granted. The required area can then be accessed by turning the knob.

## Simple installation

The digital cylinder can be installed directly on doors made of wood, glass, plastic or metal, both indoors or outdoors. It couldn't be simpler: the cylinder is installed in the existing door lock in a matter of minutes, as the internal knob can be clipped on without the need for tools.

## Modular design

The digital cylinder is made up of a small number of modular parts. Both the external and internal knob can be dismantled for easy installation. The cylinder length can be adjusted as required on the spot. The CR2 battery used in the outside knob is accessed using a special tool.

## Scalable application

Suitable for single doors but also as part of a large-scale master key system, choose among various programming options:

- Manual programming: the easiest way - just hold up the master media and reprogram the relevant door component.
- Using programming device: Whitelist programming on PC with Kaba evolo Manager (KEM) and transfer via programming device.
- With CardLink: access rights are stored via the update terminal onto the access media. Doors don't have to be re-programmed manually.
- Using the wireless option: authorisations can be transferred to the access components from the comfort of your own desk.
- Using Open Security Standards - Standard Offline (OSS-SO): integration of evolo components into 3rd party systems (LEGIC only)

## Important evolo features

- Unlimited number of access media can be managed
- Event memory for up to 2000 door movements (can be switched off)
- 15 configurable time profiles, each with 12 time windows
- 20 holiday periods and 64 special days
- Time-limited granting of user rights (validation)

## A universal portfolio

Our product range includes many products in the same high-quality design that can be combined seamlessly with one another. These can be integrated into our mechanical, standalone or online systems, according to customer requirements.

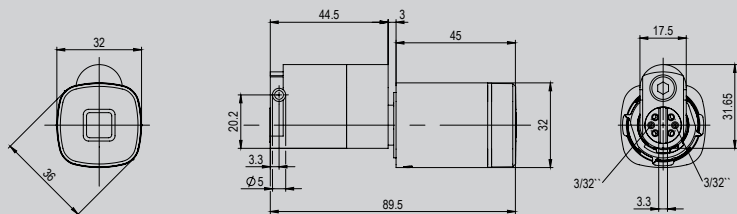

dormakaba Australia  
Head Office  
46-52 Abbott Road  
Hallam VIC 3803  
T: 1800 675 411  
info.au@dormakaba.com  
www.dormakaba.com.au

dormakaba New Zealand  
Head Office  
Building P, 61-69 Patiki Road  
Avondale, Auckland 1026  
T: 0800 436 762  
info.nz@dormakaba.com  
www.dormakaba.co.nz

## Technical data

### Supported RFID standards

- LEGIC (advant & prime)
- MIFARE (DESFire & Classic)
- OSS-SO (LEGIC advant, version 1.00)

### Versions

- Euro profile and Australian oval cylinder
- Types Euro: Standard, half and dual
- Finishes: nickel-plated (stainless steel look), polished brass, black, bronze look
- 'Protected' option: high pick resistance (insurance category BZ+)
- Antenna cover: black or white

### Dimensions

- Cylinder length: from 30/30 mm
- Adjustable in 5mm increments (Euro profile only)
- Max. cylinder length: 220 mm
- External knob: Ø 36 x 45 mm
- Internal knob: Ø 36 x 29 mm
- Small internal knob: Ø 30 x 27 mm

### Radio interface

- IEEE 802.15.4

### Power supply

- Battery: 1 x 3 V CR2 lithium

### Environment/service life

- Temperature: -25°C to +70°C
- Protection type: up to IP56 (outside)
- Humidity: 0 to 95%, non-condensing
- Battery life at 20°C: up to 50,000 cycles or up to 3 years

### Certificates

- Insurance category BZ+ ('Protected' option)
- Fire safety: EN 1634-2: 95 mins.

Further details and order information can be found in the relevant evolo catalogue or system description.

Subject to technical alterations. kaba digital cylinder\_Australian version\_06/17