

Installation Instructions for Armature Catch Plate Kits



Description - Door holder catch plate kits

Model Number	type
ACC, CP SHORT	Short Armature (1-5/8")
ACC, CP LONG	Long Armature (2-5/8")

Mounting Armature Assembly

NOTE: Mount the armature assembly vertically (Figure 2) to obtain the correct alignment with the electromagnet.

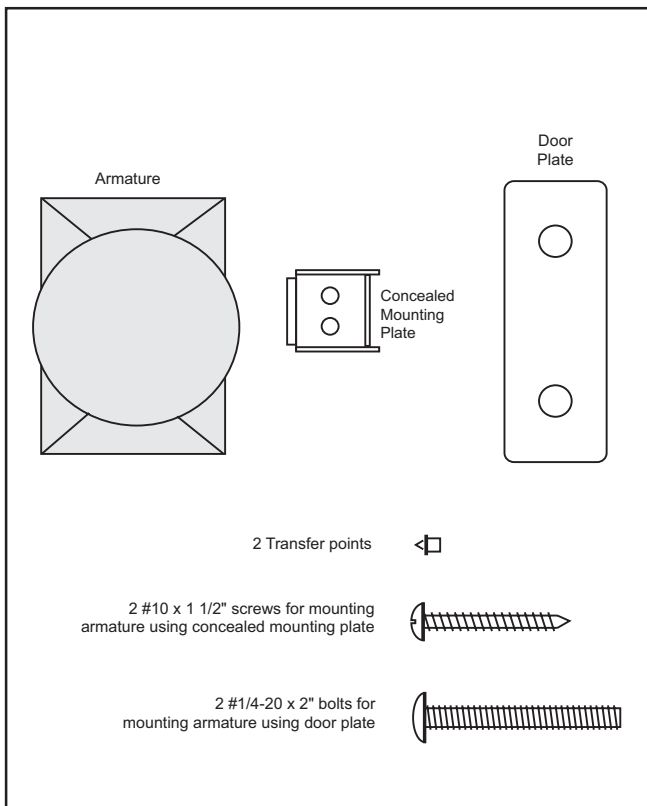

Figure 1. (Contents of kit)

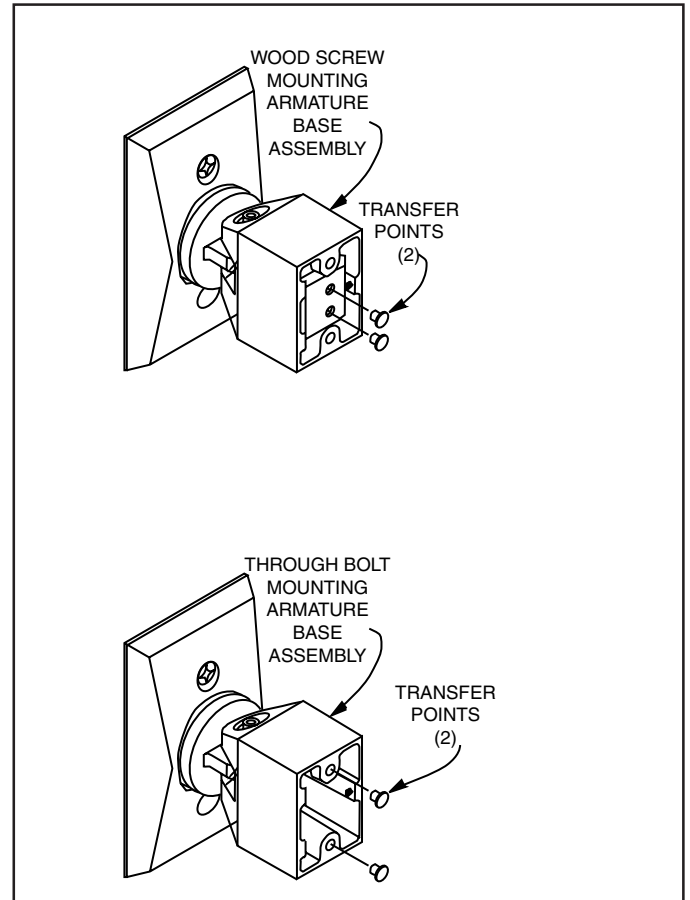

Figure 2. (Mounting Armature Assembly)

Note:

There are two armature mounting options: one for hollow metal and composite doors, and the other for solid ore wood doors.

1. Using a 5/32" Allen wrench, turn the contact plate adjusting screw (Figures 3 & 4) counterclockwise just enough to loosen the contact plate.
2. Place the transfer marking points in the armature mounting holes (Figure 2).
3. Holding the contact plate centered against the magnet, open the door and press against the transfer marking points on the armature base. This locates the two mounting holes in the door. Release the door, and remove the transfer marking points. Select a mounting method.

4a. Thru-bolt mounting (Figure 3). Recommended for standard 1-3/4" hollow metal, hollow core, or composite type wood doors. Center punch the two marked points and drill 5/16" diameter through door. The distance between their center should equal 1-3/4". If a 2" door is used, two (2) 2-1/4" long 1/4 - 20 bolts are recommended (Figure 3).

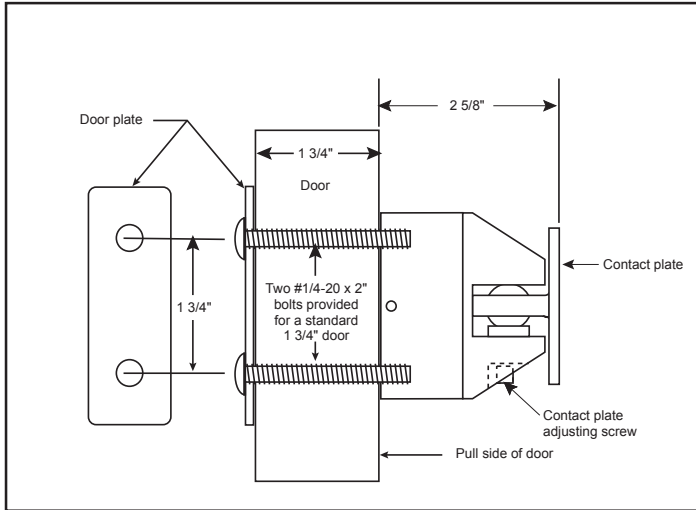

Figure 3. (Thru-bolt mounting)

4b. Surface concealed mounting (Figure 4). Not recommended for hollow metal, hollow core or composite type wood doors. Center punch the two marked points and drill 1/8" diameter 1-1/4" deep. The distance between their center points should equal 1/2". Install the concealed mounting plate using the two #10 X 1-1/2" screws provided (Figure 4).

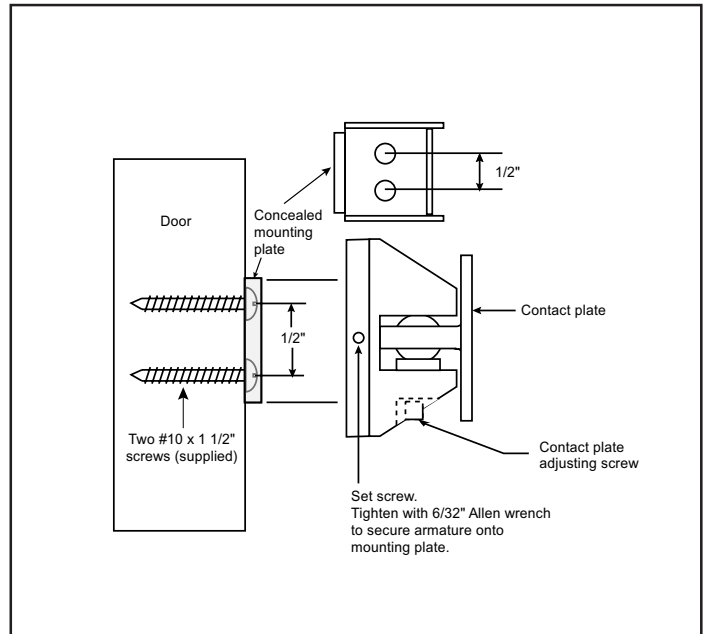

Figure 4. (Surface concealed mounting)

5. Secure the armature assembly to door, using Figure 3 or Figure 4 as a guide. The contact plate adjusting screw should face upward.
6. Align the contact plate against the electromag net (it must be centered and lie flat against the magnet to ensure sufficient holding force. Tighten the contact plate adjusting screw. Do not overtighten. The plate must be firm but not overly rigid.
7. Check alignment and adjust if necessary.
8. Adjust the door closer to exert 3 pounds of force when the door is open and the armature and magnet are in contact.
9. Energize the electromagnet and open the door. If the door shuts, check the alignment of the contact plate and electromagnet. Also check that power is turned on to the unit and that the magnet is energized.

P/N 3101145 OFFSET SPEC

**INSTALLATION INSTRUCTIONS FOR EMEXT
SERIES DOOR HOLDER EXTENSION KITS**

**(1) 8 1/2" X 11" SHEET PRINTED BOTH SIDES.
FOLD IN QUARTERS PER FOLD DETAIL PART
NO. ON THE OUTSIDE**

**MATERIAL: STANDARD WHITE OFFSET
STOCK**

**CHARACTERS: TO BE BLACK ON WHITE BACK-
GROUND**

**NOTE: MECHANICALS HAVE ALREADY BEEN
REDUCED TO ACTUAL SIZE.**

**RETURN MECHANICALS TO:
TECHNICAL WRITING
EDWARDS SIGNALING
& SECURITY SYSTEMS
41 WOODFORD AVENUE
PLAINVILLE, CT 06062**

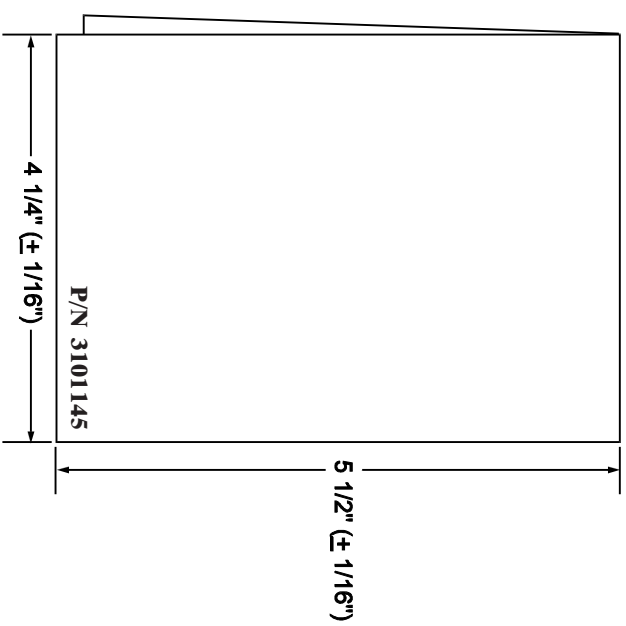

FOLD DETAIL REFERENCE ONLY

**ECN: 06-C1805
Issue: 2
File: 3101145
Approved by: GM**