	dormakaba Deutschland GmbH Postfach 4009 58247 Ennepetal		20	
	0432-CPR-00026-33	EN 1154:1996/A1:2002/AC:2006	4	8
DOP_0180			1	1
			3	1
			4	1

Änderungen vorbehalten
 Subject to change without notice

NOTE: DC function does not fulfill requirements of EN1154 in parallel arm mounting.

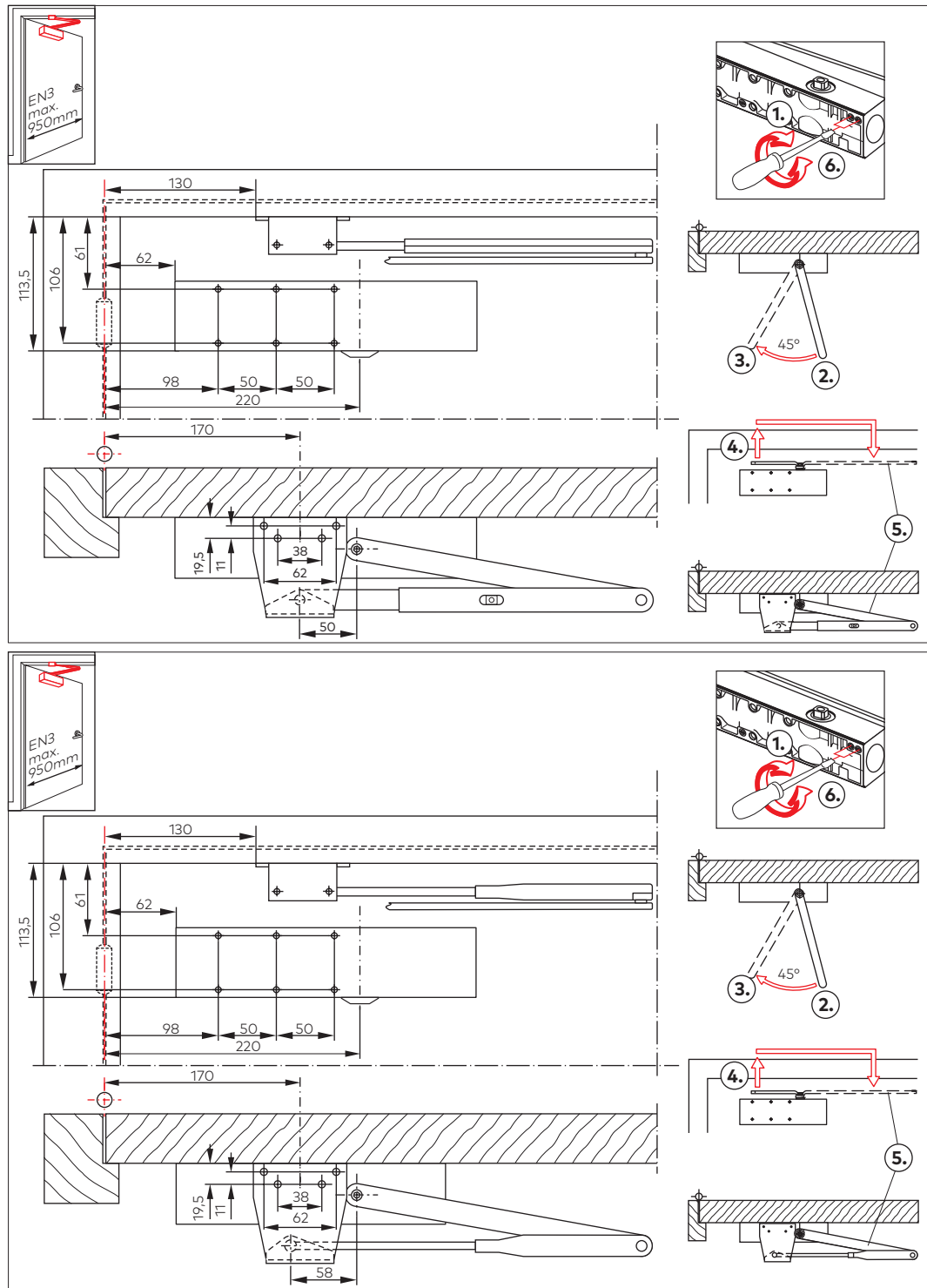

TS 73V EN 1-4

Mounting instructions

WN 057060 45532 - 2020-11

EN